

此页不印刷

形式：骑马钉（24P）

尺寸：159x110mm

材质：120g双铜

工艺：单色 双面印刷，封面覆哑膜

USER MANUAL

Electric Bike

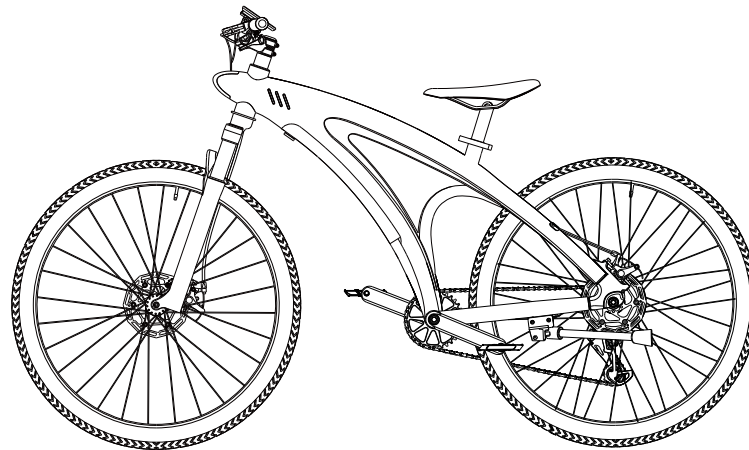

Ver: 2.0



To ensure safe use, please read the instruction manual carefully.

This instruction manual contains important safety information and tips, please read it carefully. Do not use the electric bike before you read it. Keep the instruction manual properly.

About the manual

·Thank you for choosing our electric bike series products!

·The safety instructions and precautions for electric bike are introduced in the user manual, Please read it carefully for the first using. If it is not used in accordance with the instructions in the manual, it may cause danger, and the company will not bear any responsibility for the personal injury or property loss caused by this!

·For the safety of you and others, please read the manual carefully before using to ensure that you can drive correctly and safely!

·If you have any questions during use, or cannot get the information from the manual, please contact your dealer in time!

Content

1. Packing list	4
2. Function Introduction	5-6
3. Product assembly	7-10
4. How to ride	11-13
5. Safety notes	14-18
6. Battery instructions	19-20
7. Basic parameters	21
8. Daily maintenance	22
9. Warranty card	23

Packing list

1.1.Product

Electric Bike*1

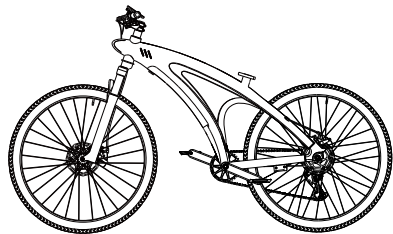

1.2.Accessories

Seat*1



Pedal*2



Wrench*2



Quick release*1



Charger*1

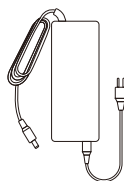

Kickstand*1



User Manual*1



* If anything missed, please contact the dealer in time!

Function Introduction

2.1 Overall View

1. Rear wheel brake
2. Grip
3. Light & Function button 
4. Front wheel brake
5. Throttle
6. Gear shift adjustment
7. Display

8. Front light
9. Frame
10. Battery
11. Brake
12. Wheel
13. Seat

14. Seat adjustment wrench
15. Motor
16. Pedal
17. Foot stand
18. Gearwheel

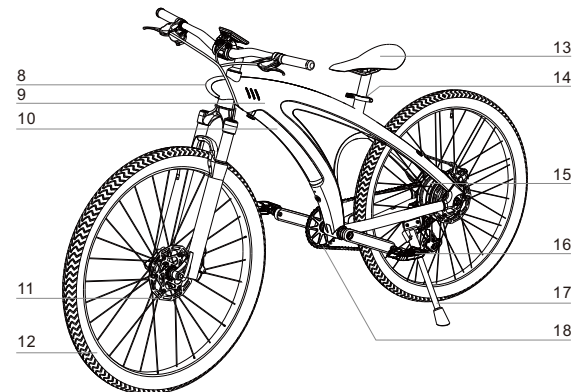
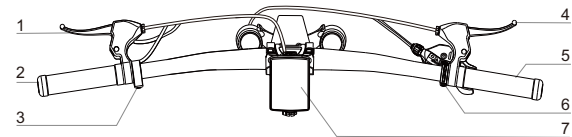

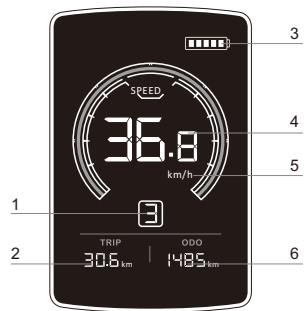

- 1.Speed model
- 2.Trip distance (TRIP)
- 3.Battery Level
- 4.Current speed
- 5.Speed unit
- 6.Total Mileage (ODO)

2.2 Instructions of Buttons

Power Button ON/ OFF:

Hold button for 3 seconds to switch on/off electric drive system.

Note:

The system will automatically turn off if left idling for more than 10 minutes.

Assist mode:

Press ⊕ or ⊖ buttons to select the desired assist level for electric system. The lowest is Level 1 and the highest is Level 3. User Can Select by self.

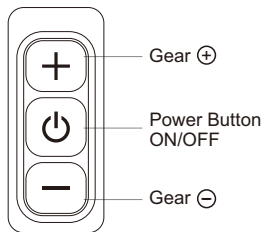

Product assembly

3.1 Open and fix the handle bar of the electric bike

Handlebar installation method:

- 1.Remove the 4 screws in front of the stem with the allen wrench provided with the bike.
- 2.After placing the handlebar into the stem.
- 3.Fasten the fasteners and place the screws into the stem to lock.

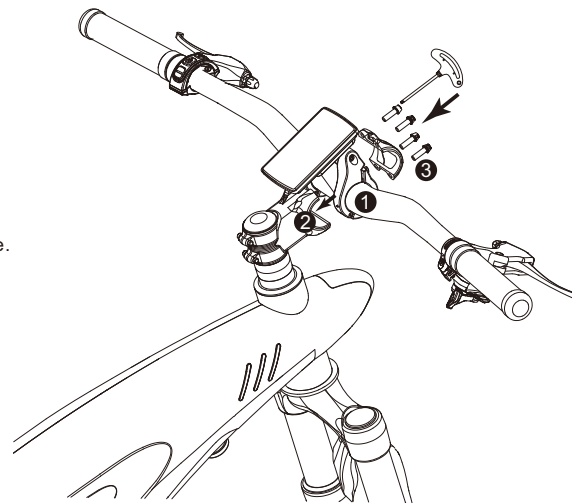

3.2 Install front

Install the front wheel on the front fork, and lock the quick release wrench.

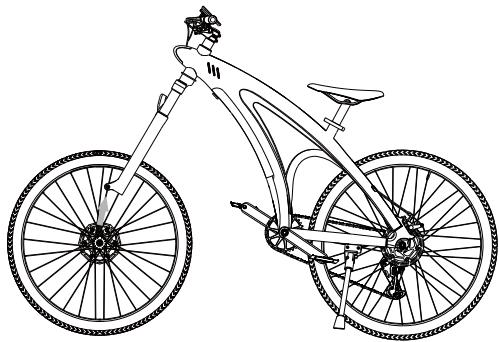

3.3 Install pedal

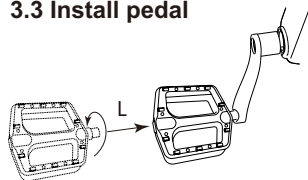

1. Left

Install the pedal marked with "L" on the left crank, and pay attention to the thread direction of the pedal is counterclockwise assembly.

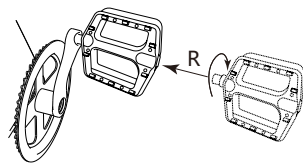

2. Right

Install the pedal marked "R" on the right crank, and pay attention to the clockwise thread direction of the pedal during installation.

3.4 Battery installation

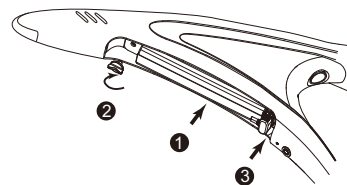

1. Align and insert the battery terminal side with the frame, and then press the battery lock end to lock it.

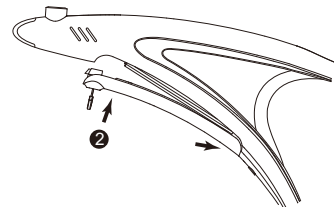

2. Put the bottom of the battery cover into the frame, and press the battery lock into the bike frame to lock it.

3.5 Battery removal diagram

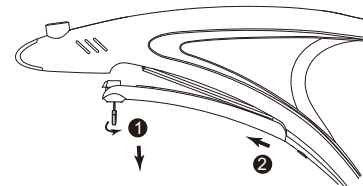

1. Turn the key counterclockwise to open the battery lock and remove the battery cover.

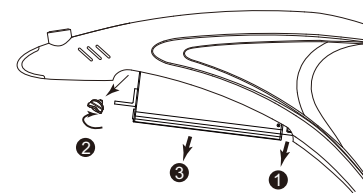

2. Unplug the power terminal, remove the battery fixing screw counterclockwise, and take out the battery.

3.6 Install the bike seat

Open the seat tube locking wrench, insert the seat into the tube, adjust the height of the seat and tighten the wrench.



Note: Pay attention to the safety line when adjusting the height of the seat. The safety line cannot exceed the saddle tube to prevent danger!

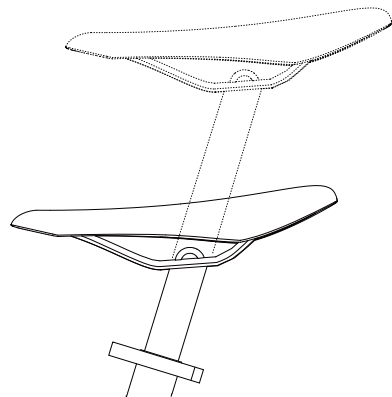

How to ride

1. There is a risk of falling and injury during riding, so please wear helmets, knee pads, elbow pads and other protective tools.
2. Adjust the seat to a height suitable for your comfortable riding (appropriate height: when the foot is at the lowest point, the knee angle is about 25 to 35 degrees, this height is the most suitable).
3. Press and hold the power button to start up and check the battery power.

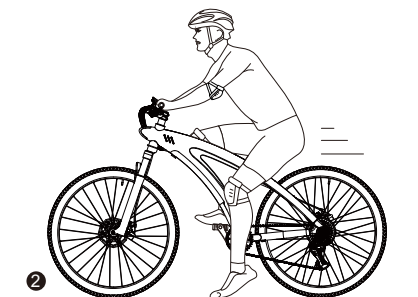
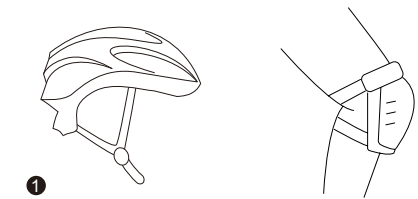
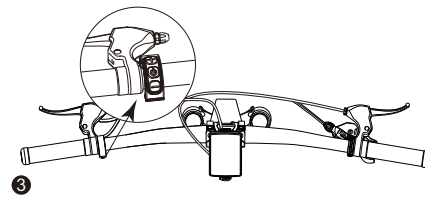

4. Hold the brake tightly, straddle the bike with your right foot, step on the pedal and sit down.

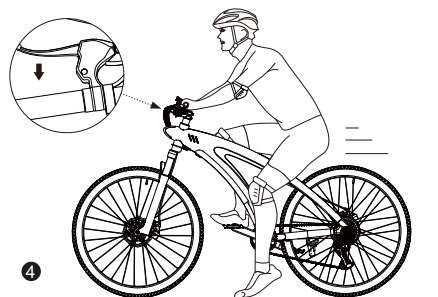

5. Slowly release the brake and press the left foot lightly on the ground to make the bike start to slide forward slowly. At the same time, use your right foot to push forward forcefully. Step on the left foot pedal to start pedaling alternately. Hold the handlebar firmly with both hands. Just like riding a bike.

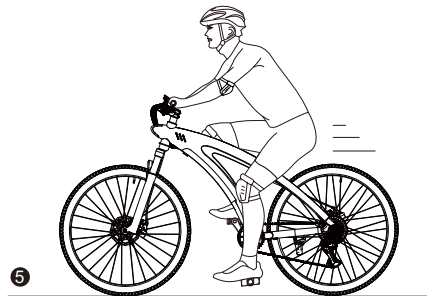

6. This electric bike provides three riding modes (fitness mode, electric assist mode, electric mode).

a. Fitness mode: Turn off the electric lock and ride full-time manually, just like riding an ordinary bike to achieve the goal of fitness.

b. Electric power-assisted mode: Turn on the electric door lock, and the electric vehicle control system will automatically output an electric power-assisted according to the intensity of the pedaling during riding, making the riding very easy, and the battery life can reach the maximum mileage.

c. Electric mode: Turn on the electric power and turn the accelerator to ride in electric mode. You don't need to step on the pedals manually, which can save physical effort and ride easily.

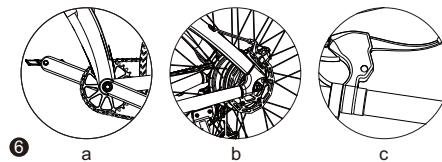

⚠ Note:

When used for the first time, the throttle should be slowly turned to speed up, to prevent the acceleration caused by too fast then out of control!

7. Loosen the throttle knob can slow down the speed, vigorously grip the brake handle to do emergency brake.

⚠ Note:

1. When riding in rain and snow, the braking distance will be extended, so please pay attention to slow down.

2. Use the rear brake during normal driving, and the front and rear brakes should be used together for emergency braking. Do not use the front brake for emergency braking during high-speed driving, as the front brake at high speed may cause the danger of rolling over!

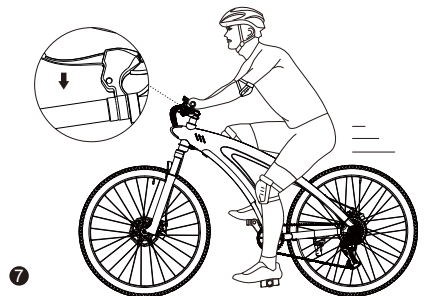

Safety notes

1. Please follow the traffic laws and regulations when using electric bike. It is forbidden to ride electric bike into the motorway.

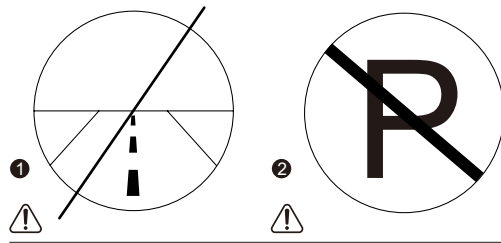

2. Electric bike should not be parked in the building foyer, evacuation corridor or safety exit.

3. It is prohibited to ride on the road with severe water accumulation. The road condition of the water accumulation is unknown, which may easily cause danger.

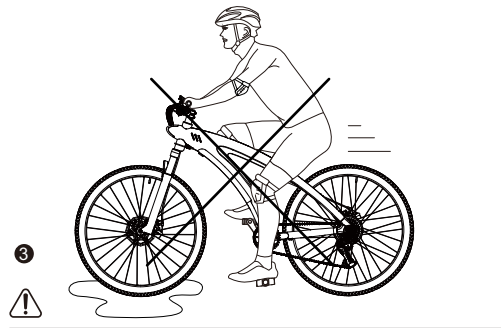

4. Do not ride electric bike after drink.

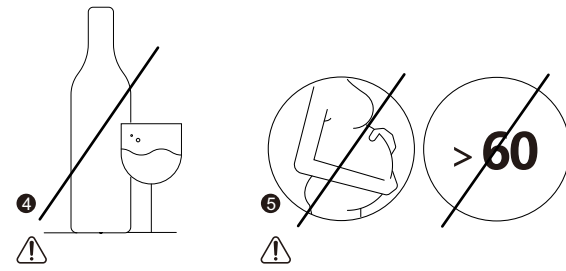

5. It is forbidden for pregnant women or users over 60 years old.

6. It is prohibited to ride electric bike up and down stairs or jumping obstacles.

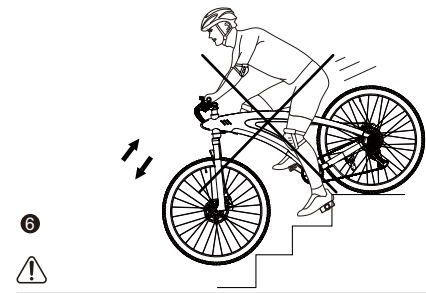

7.The maximum load of electric bike is 120kg.

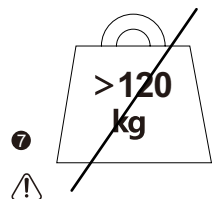

8.It is forbidden for multiple people to ride the same electric bike at the same time or ride with children in their arms.

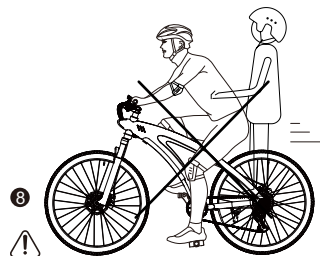

9.It is forbidden to leave the handlebar with both hands while riding.

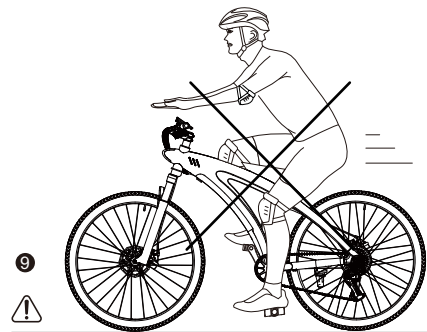

10.It is forbidden to modify the electric bike by yourself. It may cause unstable operation of the electronic system and cause danger when riding.

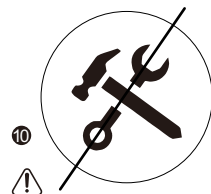

11.It is forbidden to modify the battery of an electric bike without permission. Modification of the battery is dangerous, and improper operation may cause the battery to explode or catch fire.

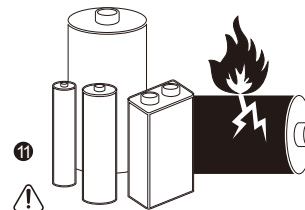

12.Please try to avoid riding in rain or snow. If you need to ride, slow down and avoid emergency braking.



13. Before riding an electric bike, please check the body and tires carefully to ensure that there are no signs of looseness or damage.

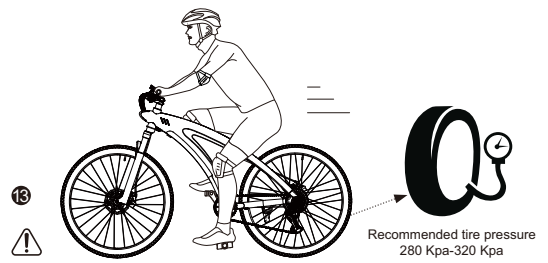

14. When riding, braking, please observe the intersection to avoid unnecessary damage to yourself or surrounding objects, people and small animals.

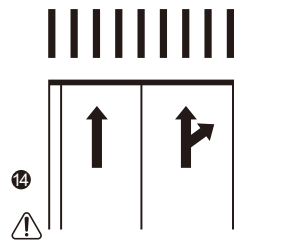

15. Please Turn off power button ON/OFF when walking with electric bike prevent accidental acceleration of the throttle.

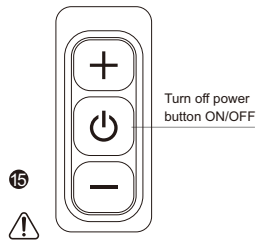

Battery Instructions

The instruction shows how to charge and maintain the battery, some safety notices and the specification. Please use the battery properly according to this instruction to prolong the battery life and its performance.

6.1 Battery Parameters

Name	Parameter
Type	Li-ion battery
Voltage	46.8V
Battery Capacity	13Ah
Max Charging Voltage	54.6V
Max Charging Current	2A
Charging Time	6-7 hours
Working Temperature	-10°C-40°C
Charging Temperature	0°C-40°C
Store Time(-10°C -40°C)	3 months (full charge)

6.2 Battery Safety

- In order for the electric bike to work stably and efficiently, the battery must be charged and used within the temperature range required by the battery specification.
- Before installing and using the battery, please unplug the charger. It is dangerous to do anything related to the electric bike during the charging process.
- It is forbidden to disassemble or pierce the battery pack shell to avoid short circuit caused by metal objects contacting the battery contacts, otherwise it may cause battery damage or personal injury.
- It is forbidden to throw the battery into water, fire (including near stove, heater, etc.) or expose it to high temperature (50°C), otherwise it may cause battery failure, overheating, or even risk of fire.
- Water in the battery may cause damage to the internal circuit and risk of fire or explosion. If the battery is suspected of being exposed to water, please stop using the battery immediately and send it to after-sales testing.
- Only use the original charger to charge, otherwise there is a danger of damage to the battery or fire.
- If the battery is damaged, emits peculiar smell, smoke or overheating, please do not continue to use the battery, and avoid other objects in contact with the battery.
- Please fully charge the battery before storing after each use, which will help extend the battery life.
- Do not place the battery in a high temperature higher than 50°C or a low temperature environment lower than -10°C.
- When not in use for more than 30 days, please fully charge it first, store it in a cool and dry place, and fully charge it at least once every 90 days, otherwise the battery may be damaged and this damage is not covered by the warranty.
- Avoid recharging when the battery is completely exhausted, and try to charge as soon as possible, which can greatly extend the battery life. In addition, when used at room temperature, the battery pack can exert a higher range and performance; and if used in an environment below 0°C, the battery life and performance will decrease. Typically, in an environment of -10°C, the cruising range may be only half or lower than that at room.
- Improper disposal of used batteries may seriously pollute the environment.
- Please abide by local regulations when disposing of this battery pack.

**Notice:**

1. When the internal temperature of the battery exceeds 50°C, the battery is in a protected state and cannot be charged!
2. A fully charged e-bike drains its stored charge after approximately 90-120 days of standby. If it is not charged in time, it may cause damage to the battery due to excessive discharge. This damage is irreversible and out of free warranty.

6.3 Charging steps

Open the dust cover on the battery, insert the DC plug of the charger into the charging base of the battery, and then plug the AC plug of the charger into the AC power (100-240V; 50/60Hz) socket, the indicator is red and charging starts.

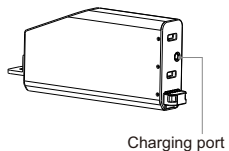
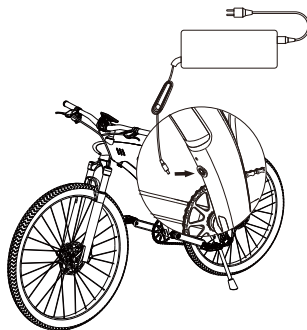
Charging method A:**Charging method B:**

When charging, you can only use the original standard power adapter. Do not use any other to avoid danger caused by power mismatch.

Parameter

Bike specification	
Product name	Electric bike
Unfold size	1800*745*1050mm
Net weight	28kg
Max load	120kg
Max speed	50km/h
Max range with power assistant mode	70km
Climbing angle	25°
Working temperature	-10-40°C
Store temperature	-10-40°C
Battery specification	
Rated voltage	46.8V
maximum charging voltage	54.6V
Capacity	13Ah/608.4Wh
Motor parameter	
Mode of motor	Permanent magnet brushless
Motor power	650W
Rated voltage	48V
Charger parameter	
Input voltage	100-240Vac 50/60Hz
Input current	2A MAX
Output voltage	54.6V DC
Output current	2A
Charging time	6-7H
Tire	
Tire size	27.5 inch
Recommended tire pressure	280 Kpa - 320 Kpa

Daily maintenance



Reminder:

- It is forbidden to use alcohol, gasoline, kerosene or other corrosive and volatile chemical solvents to clean, otherwise it will seriously damage the appearance and internal structure of the bike.
- It is forbidden to use high-pressure water guns to spray and flush. When cleaning the electric bike, make sure the bike is turned off, and the charger has been unplugged and the dust cover of the charging port has been fastened, otherwise it may cause electric shock or major failure due to the bike was flooded.
- Electric bike need to be stored in a cool and dry indoor place. Try to avoid storing outdoors for a long time. Sun exposure, overheating, and cold outdoor environments will accelerate the appearance of electric bike and tire aging, and reduce the use of electric bike and their lithium battery life.

8.1 Cleaning and storage of electric bikes

If there are stains on the surface of the electric bike, Wipe with a damp soft cloth; if the plastic parts of the body are scratched, Use sandpaper or other abrasive materials for polishing.

8.2 Inflation and maintenance of tires

The tires of this product are pneumatic tires. When the tire height sinks 20%-30%,it needs to be inflated.The recommended inflated tire pressure is 280 Kpa - 320 Kpa. The tire is inflated at least once in 2-3 months. Regular inspection of the inflation can reduce the puncture situation and extend the life of the tire.

Warranty card

9.1 The product has passed the inspection of the quality control department and allowed to be sold.

Please keep the warranty card and purchase invoice properly, and present the warranty card and purchase invoice when repairing.

Effective date :

Quality inspection pass seal:

9.2. Warranty Card

Username		Gender	
Mailing address		Age	
Phone		Zip	
Purchase address			
Price			
Description & Specification			
Dealer signature			
Sales order number			
Body number			
User signature			



Please keep the warranty card and purchase invoice as after-sales proof. This card must be provided during the warranty. If this card is not provided or the card is altered privately, the company has the right to do non-warranty treatment!